

# BF(VERTICAL) GEAR MOTORS

## BF ( VERTICAL ) TYPE DIMENSIONS

## BF MODEL CODE

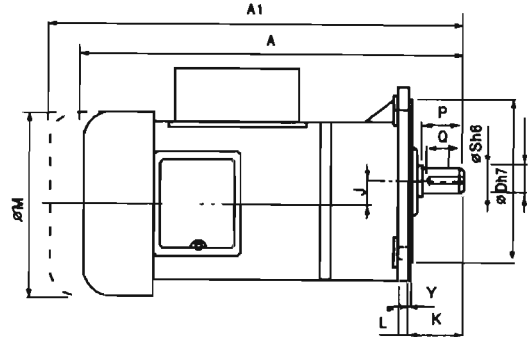

### MOTOR CODING SYSTEM

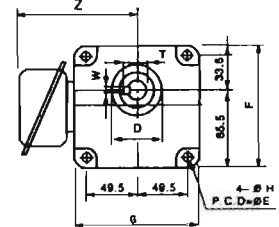
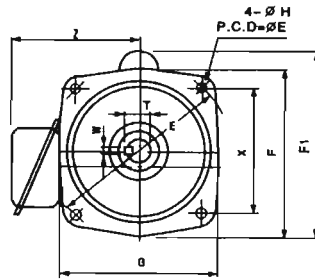
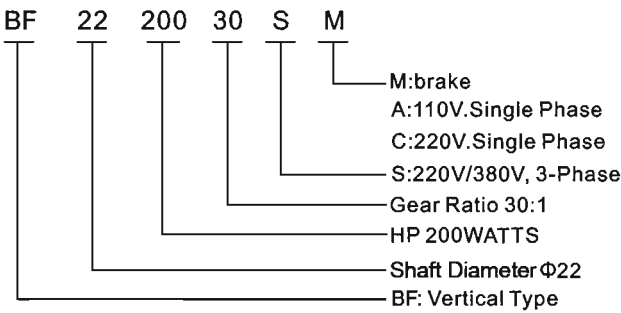

### BF DIMENSIONS

HP	Gear Ratio	Type	A1	A	D	E	X	F	F1	G	H	L	J	K	M	Y	Z	Output shaft					Weight kg	Remark
																		P	Q	S	T	W		
0.1KW 1/8HPx4P	5~50	18	285	246.0	50	140	99	120	160	120	9	12	15.98	40	127	5	105 (120)	30	27	18	20	5	5.5	A1Flange
	60~200	22	317	280.0	148	185	131	173	-	163	11	12	17.66	50	127	3	105 (120)	40	35	22	25	7	7.3	A2Flange
	250~1800	22	387	366.0	148	185	131	173	-	163	11	12	17.66	50	127	3	105 (120)	40	35	22	25	7	9.2	A2Flange
	250~1800	28	415	396.5	170	220	156	204	-	193	$\Phi 12$	13	23.11	55	127	4	105 (120)	45	40	28	30	7	11.9	A2Flange
0.2KW 1/4HPx4P	5~10	18	320	280.0	50	140	99	120	160	120	9	12	15.98	40	127	5	105 (120)	30	27	18	20	5	6.5	A1Flange
	12.5~25	18	320	280.0	50	140	99	120	160	120	9	12	15.98	40	127	5	105 (120)	30	27	18	20	5	6.5	A1Flange
	12.5~100	22	350	314.0	148	185	131	173	-	163	11	12	17.66	50	127	3	105 (120)	40	35	22	25	7	8.3	A2Flange
	100~200	28	382	340.0	170	220	156	204	-	193	$\Phi 12$	13	23.11	55	127	4	105 (120)	45	40	28	30	7	11.7	A2Flange
	250~1800	28	449	430.5	170	220	156	204	-	193	$\Phi 12$	13	23.11	55	127	4	105 (120)	45	40	28	30	7	12.8	A2Flange
0.4KW 1/2HPx4P	250~1800	32	499	492.6	185	255	180	240	-	220	13	16	30.22	70	127	4	105 (120)	55	50	32	35	10	25.5	A2Flange
	5~10	22	377	330.0	148	185	131	173	185	163	11	12	17.66	50	160	3	105 (120)	40	35	22	25	7	11	A2Flange
	12.5~25	22	377	330.0	148	185	131	173	185	163	11	12	17.66	50	160	3	105 (130)	40	35	22	25	7	11	A2Flange
	12.5~100	28	410	355.0	170	220	156	204	-	193	12	13	23.11	55	160	4	105 (130)	45	40	28	30	7	13.4	A2Flange
	100~200	32	445	390.0	185	255	180	240	-	220	13	16	30.22	70	160	4	105 (130)	55	50	32	35	10	24.4	A2Flange
0.75KW 1HPx4P	250~1800	32	526	508.5	185	255	180	240	-	220	13	16	30.22	70	160	4	105 (130)	55	50	32	53.5	10	26.8	A2Flange
	250~1800	40	599	560.0	230	310	219	295	-	270	15	21	37.96	81	160	5	-	65	60	40	44.5	10	47.4	A2Flange
	5~25	28	433	375.0	170	220	156	204	-	193	12	13	23.11	55	160	4	105 (130)	45	40	28	30	7	15.1	A2Flange
	30~120	32	468	410.0	185	255	180	240	-	220	13	16	30.22	70	160	4	105 (130)	55	50	32	35	10	26.9	A2Flange
	100~200	40	520	445.0	230	310	219	295	-	270	15	21	37.96	81	160	5	105 (130)	65	60	40	44.5	10	47.4	A2Flange
1.5KW 2HPx4P	250~1800	40	623	580.0	230	310	219	295	-	270	15	21	37.96	81	160	5	105 (130)	65	60	40	44.5	10	49.7	A2Flange
	250~1800	50	674	640.0	250	390	276	360	-	335	19	20	51	90.5	160	5	-	80	75	50	55	14	62.9	A2Flange
	5~30	32	470	445.0	185	255	180	240	-	220	13	16	30.22	70	193	4	138 (145)	55	50	32	35	10	31.2	A2Flange
2.2KW 3HPx4P	40~100	40	525	480.0	230	310	219	295	-	270	15	21	37.96	81	193	5	138 (145)	65	60	40	44.5	10	19.3	A2Flange
	120~200	50	580	550.0	280	390	276	360	-	335	19	20	51	90.5	193	5	-	80	75	50	55	14	64.2	A2Flange
	5~10	32	500	475.0	185	255	180	240	-	220	15	16	30.22	70	193	4	138 (145)	55	50	32	35	10	34.2	A2Flange
3.7KW 5HPx4P	15~60	40	555	510.0	230	310	219	295	-	270	15	21	37.96	81	193	5	138 (145)	65	60	40	44.5	10	50.8	A2Flange
	75~100	50	610	580.0	280	390	276	360	-	335	19	20	51	90.5	193	5	170	80	75	50	55	14	59.6	A2Flange
	5~20	40	570	525.0	230	310	219	295	-	370	15	21	37.96	81	230	5	170	65	60	40	44.5	10	56.5	A2Flange
25~60	50	630	595.0	280	390	276	360	-	335	19	20	51	90.5	230	5	170	80	75	50	55	14	64.7	A2Flange	

- 1: A1 length of the motor with brake; Single-phase 1/8 HP and 1/4HP are of the same length; Single-phase 1/4HP~1HP and three-phases are of the same length.
- 2: 1/8 HP ~1HP of brake weight about the weight based on the combined no brakes 2kg,
- 3: Appended to the 40-50 gear box type 0 rings (about 50mm height)
- 4: Z>Iron box size