

BL(HORIZONTAL) GEAR MOTORS

BL (HORIZONTAL) TYPE DIMENSIONS



BL MODEL CODE

● MOTOR CODING SYSTEM

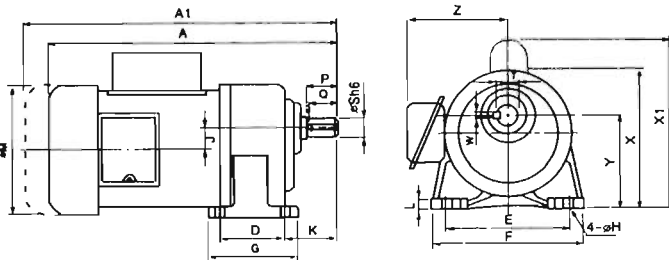
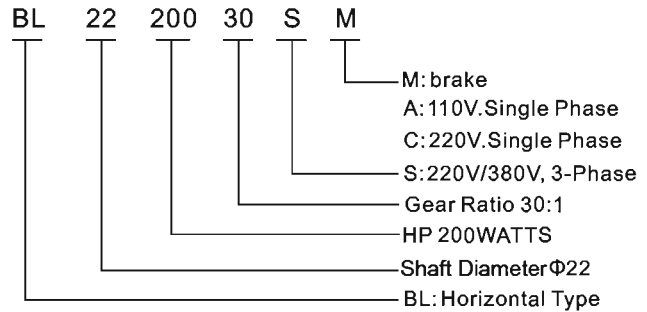

● BL DIMENSIONS

HP	Gear Ratio	Type	A1	A	D	E	F	G	H	L	J	K	M	X1	X	Y	Z	Output shaft					Weight kg
																		P	Q	S	T	W	
0.1KW 1/8HPx4P	5~50	18	285	246.0	40	110	135	65	10	11	15.98	52	127	170	130	85	¹⁰⁵ ₍₁₂₀₎	30	27	18	20	5	5.6
	60~200	22	317	280.0	65	130	158	90	11	12	17.66	60	127	172	160	97.5	¹⁰⁵ ₍₁₂₀₎	40	35	22	25	7	7
	250~1800	22	387	366.0	65	130	158	90	11	12	17.66	60	127	172	160	97.5	¹⁰⁵ ₍₁₂₀₎	40	35	22	25	7	8.9
	250~1800	28	415	396.5	90	140	180	124	11	16	23.11	65	127	188	180	116	¹⁰⁵ ₍₁₂₀₎	45	40	28	30	7	11.6
0.2KW 1/4HPx4P	5~10	18	320	280.0	40	110	135	65	10	10	15.98	52	127	170	130	85	¹⁰⁵ ₍₁₂₀₎	30	27	18	20	5	6.4
	12.5~25	18	320	280.0	40	110	135	65	10	10	15.98	52	127	170	130	85	¹⁰⁵ ₍₁₂₀₎	30	27	18	20	5	6.4
	12.5~100	22	350	314.0	65	130	158	90	11	12	17.66	60	127	172	160	97.5	¹⁰⁵ ₍₁₂₀₎	40	35	22	25	7	7.9
	100~200	28	382	340.0	90	140	180	124	11	16	23.11	65	127	188	180	116	¹⁰⁵ ₍₁₂₀₎	45	40	28	30	7	10.3
	250~1800	28	449	430.5	90	140	180	124	11	16	23.11	65	127	188	180	116	¹⁰⁵ ₍₁₂₀₎	45	40	28	30	7	12.4
	250~1800	32	499	492.6	130	170	213	167	163	20	30.22	76	127	210	210	138.5	¹⁰⁵ ₍₁₂₀₎	55	50	32	35	10	24.6
0.4KW 1/2HPx4P	5~10	22	380	330.0	65	130	158	90	11	12	17.66	60	160	190	160	97.5	¹⁰⁵ ₍₁₂₀₎	40	35	22	25	7	12.6
	12.5~25	22	380	330.0	65	130	158	90	11	12	17.66	60	160	190	160	97.5	¹⁰⁵ ₍₁₂₀₎	40	35	22	25	7	12.6
	12.5~100	28	410	355.0	90	140	180	124	11	16	23.11	65	160	201	180	116.0	¹⁰⁵ ₍₁₂₀₎	45	40	28	30	7	15
	100~200	32	445	390.0	130	170	213	167	13	20	30.22	76	160	210	210	138.5	¹⁰⁵ ₍₁₂₀₎	55	50	32	35	10	27.2
	250~1800	32	526	508.5	130	170	213	167	13	20	30.22	76	160	210	210	138.5	¹⁰⁵ ₍₁₂₀₎	55	50	32	35	10	29.6
	250~1800	40	599	560.0	150	210	260	190	15	21	37.96	85	160	250	250	160.0	¹³¹ ₍₁₃₀₎	65	60	40	44.5	10	47.2
0.75KW 1HPx4P	5~25	28	430	375.0	90	140	180	124	11	16	23.11	65	160	203	180	116.0	¹¹⁵ ₍₁₃₀₎	45	40	28	30	7	16.7
	30~120	32	465	410.0	130	170	213	167	13	20	30.22	76	160	210	210	138.5	¹¹⁵ ₍₁₃₀₎	55	50	32	35	10	29.8
	100~200	40	520	445.0	150	210	260	190	15	21	37.96	85	160	250	250	160.0	¹³⁸ ₍₁₄₅₎	65	60	40	44.4	10	47.2
	250~1800	40	620	580.0	150	210	260	190	15	21	37.96	85	160	250	250	160.0	¹³⁸ ₍₁₄₅₎	65	60	40	44.5	10	49.7
	250~1800	50	671	640.0	170	265	330	230	19	33	51.00	118	160		320	202.0		80	75	50	55	14	62.5
1.5KW 2HPx4P	5~30	32	470	445.0	130	170	213	167	13	20	30.22	76	193		210	138.5	¹³⁸ ₍₁₄₅₎	55	50	32	35	10	32.2
	40~100	40	525	480.0	150	210	260	190	15	21	37.96	85	193		250	160.0	¹³⁸ ₍₁₄₅₎	65	60	40	44.5	10	47.7
	120~200	50	580	550.0	170	265	330	230	19	33	51.00	118	193		320	202.0		80	75	50	55	14	63.4
2.2KW 3HPx4P	5~10	32	500	475.0	130	170	213	167	13	20	30.22	76	193		210	138.5	¹³⁸ ₍₁₄₅₎	55	50	32	35	10	35.2
	15~60	40	555	510.0	150	210	260	190	15	21	37.96	85	193		250	160.0	¹³⁸ ₍₁₄₅₎	65	60	40	44.5	10	49.1
	75~100	50	610	580.0	170	265	330	230	19	33	51.00	118	193		320	202.0		80	75	50	55	14	58.3
3.7KW 5HPx4P	5~20	40	570	525.0	150	210	260	190	15	21	37.96	85	230		250	160.0	¹⁷⁰ ₍₁₇₀₎	65	60	40	44.5	10	55.2
	25~60	50	630	595.0	170	265	330	230	19	33	51.00	118	230		320	202.0	¹⁷⁰ ₍₁₇₀₎	80	75	50	55	14	63.4

- 1: A1 length of the motor with brake; Single-phase 1/8 HP and 1/4HP are of the same length; Single-phase 1/4HP~1HP and three-phases are of the same length.
- 2: 1/8 HP ~1HP of brake weight about the weight based on the combined no brakes 2kg,
- 3: Appended to the 40-50 gear box type 0 rings (about 50mm height)
- 4: Z>Iron box size